

OLD FILE PLAN
PATENTS
 BOOK NO. A
 PAGE NO. 86

PLAT
 of the
RANCHO SANTA ROSA
 finally confirmed to
MARIA JESUS OLIVERA DE COTA et al.
 Surveyed under instructions from the
U. S. SURVEYOR GENERAL
 by
G. H. Thompson Dep. Sur.
 December 1868,
 Containing 15,525 Acres.
 Scale 80 Chs to 1 inch.
 Magnetic Variation 12° 30' East

Boundaries.

N ^o	Course	Distance	N ^o	Course	Distance
1.	N. 11 1/2° W.	153.50	11.	S. 85 1/2° E.	222.41
2.	N. 78 1/2° W.	116.23	12.	S. 46 1/2° E.	115.06
3.	N. 9 1/2° W.	236.23	13.	S. 55 1/2° E.	112.00
4.	S. 72 1/2° W.	16.84	14.	S. 77 1/2° E.	60.15
5.	S. 6 1/2° W.	163.63	15.	N. 75 1/2° E.	36.69
6.	West	45.00	16.	N. 49 1/2° E.	120.75
7.	S. 51 1/2° W.	71.50	17.	N. 30 1/2° W.	75.63
8.	S. 33° E.	222.00	18.	N. 13 1/2° W.	100.55
9.	N. 86° W.	291.52	19.	N. 22 1/2° W.	23.72
10.	S. 8 1/2° W.	128.27			

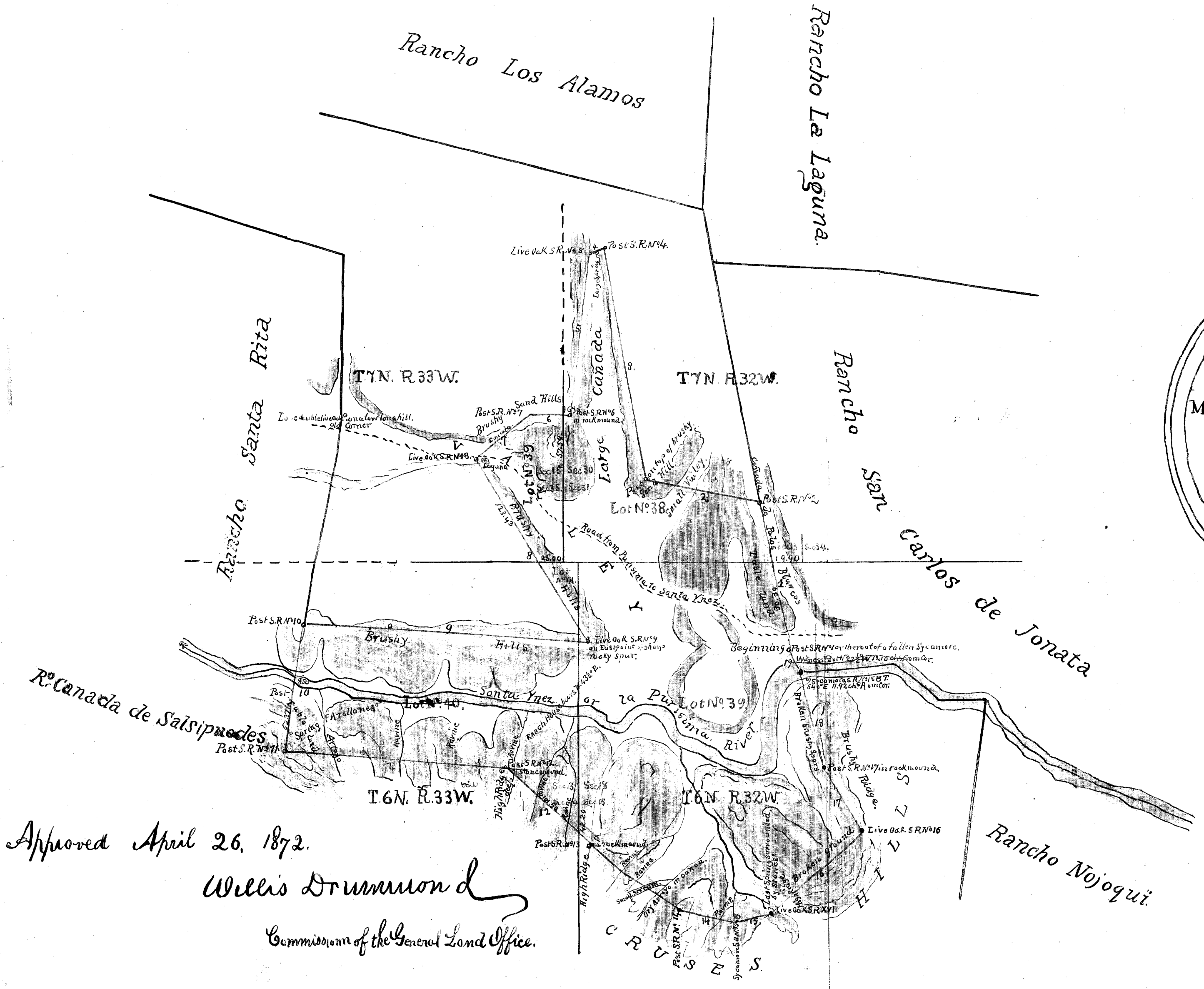

Approved April 26, 1872.
Willis Drummond
 Commissioner of the General Land Office.

(86)

Thereby certify that in accordance with the Act of Congress of July 1st 1864 this survey and plat were advertised in the "Alta California" published in the City and County of San Francisco for four weeks the date of the first publication being the 27th of January 1870, also in the "Santa Barbara Press" published in the County of Santa Barbara for four weeks the date of the first publication being the 5th of February 1870. This plat remained in this Office, subject to inspection during ninety days from the date of the first publication.

Sherran Day
 U. S. Surv. Gen. Cal.

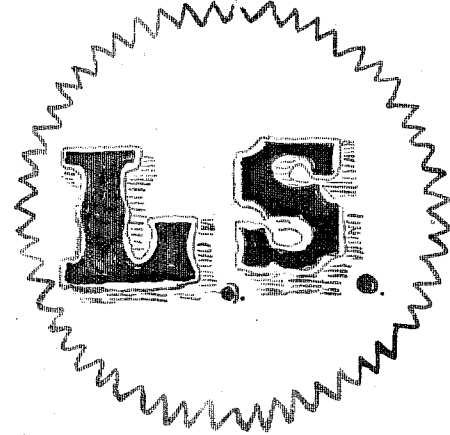

The field notes of the Rancho Santa Rosa finally confirmed to Maria Jesus Olivera de Cota et al, from which this plat has been made, have been examined and approved and are on file in this Office.
 U. S. Surveyor General's Office,
 San Francisco, California,
 November 15th 1870.

Sherran Day
 U. S. Surv. Gen. Cal.